

# ANALYSIS - MATERIAL

Bending/folding

6 mm MDF plates

Using material properties to guide the development of the design

Size of opening relating to view through

Angle of intersection relating to how light is reflected

The rule

at least 3 intersections to other bent plates

Network of forces

Everything is connected

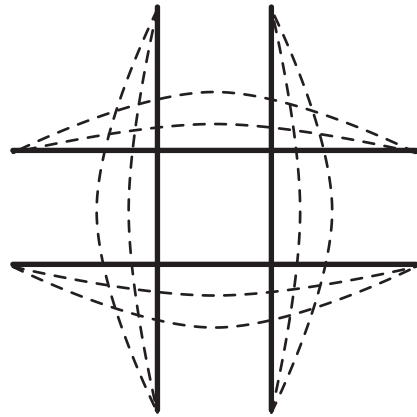
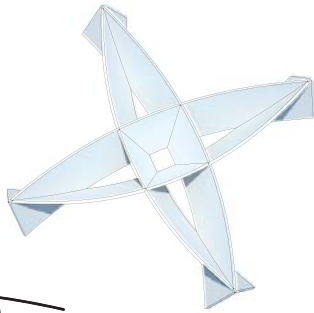

# RECIPROCAL STRUCTURES

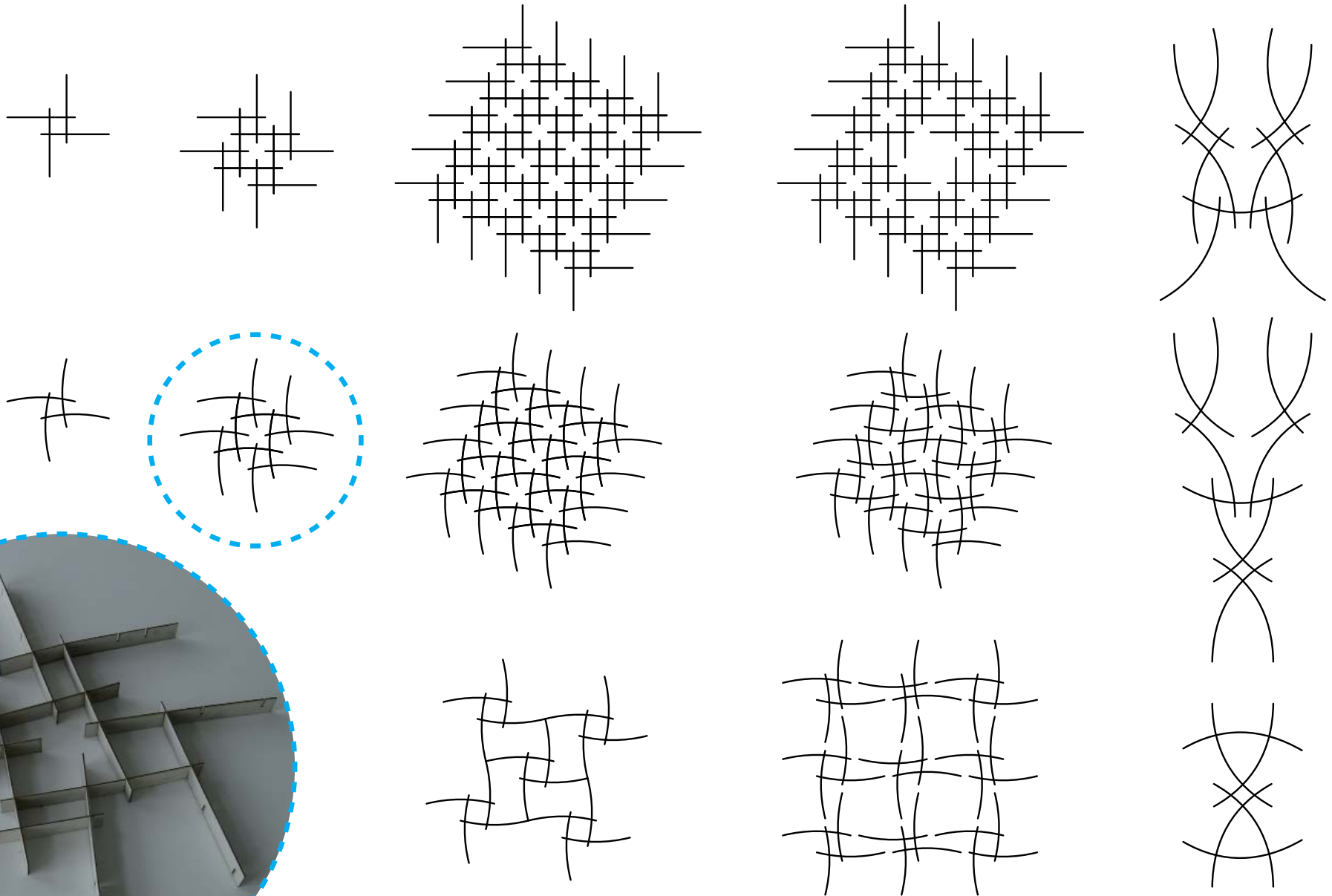

# 1 GENERATION PROTOTYPE

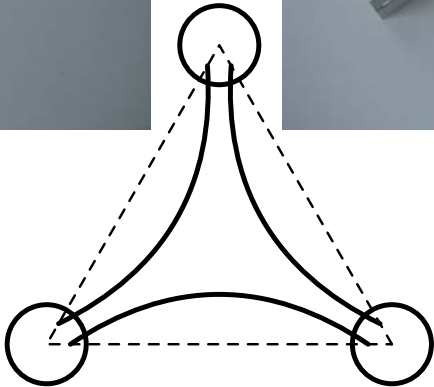
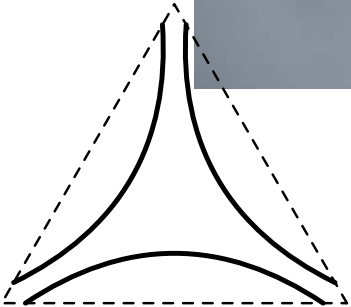
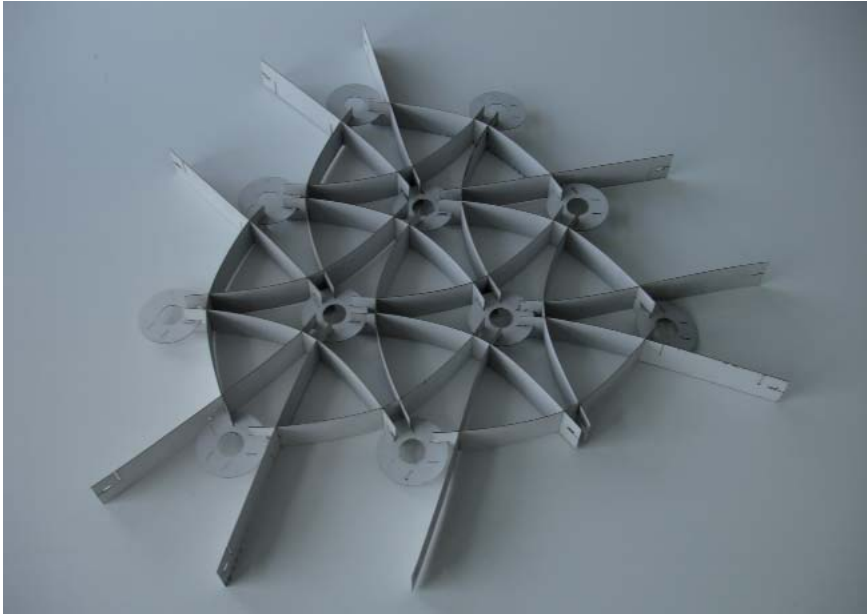
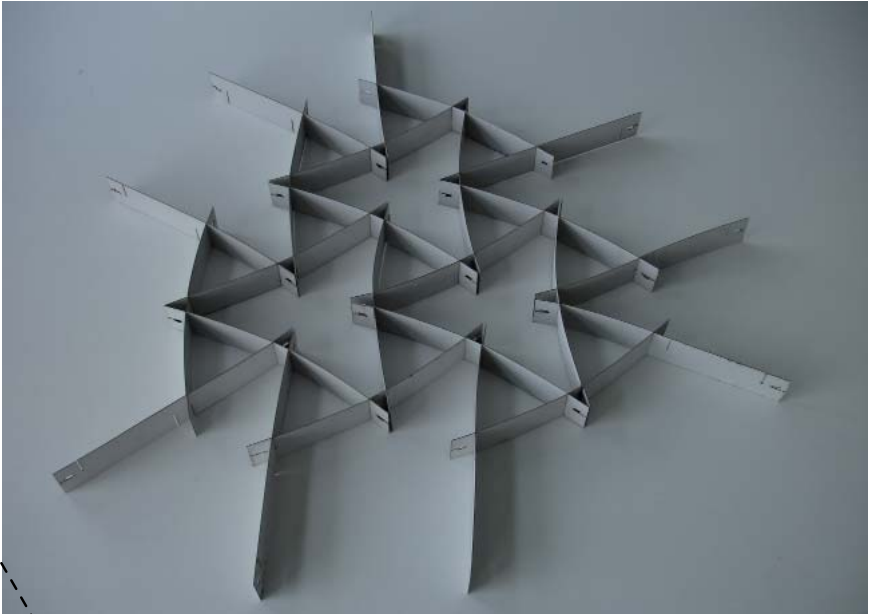
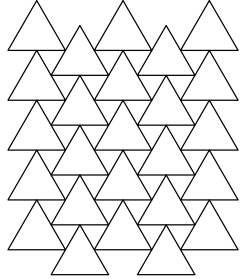
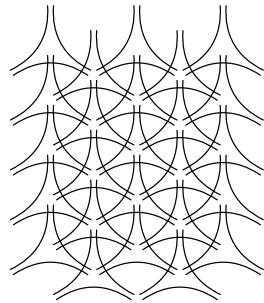
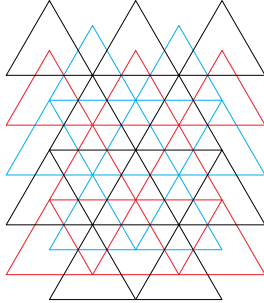

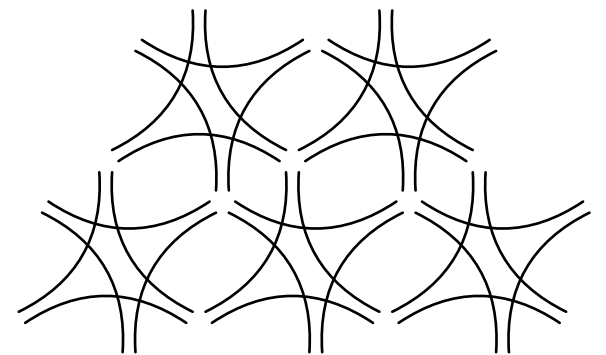
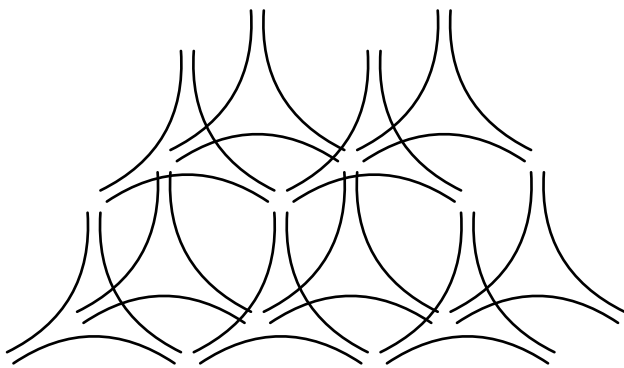
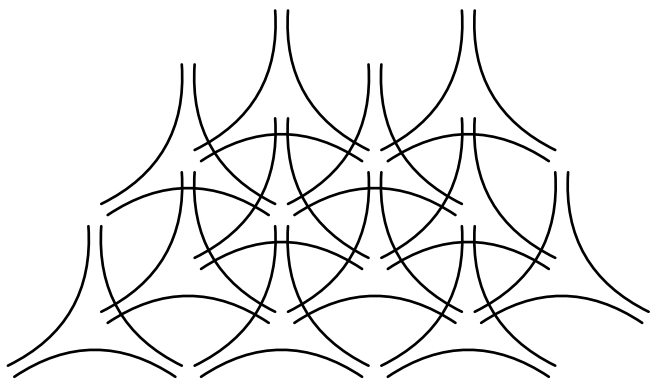
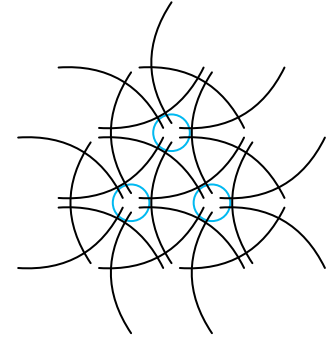
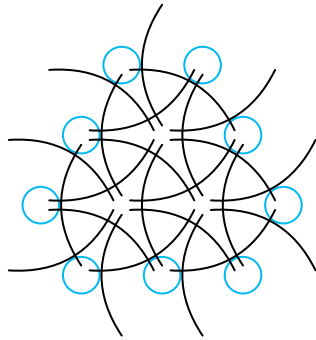
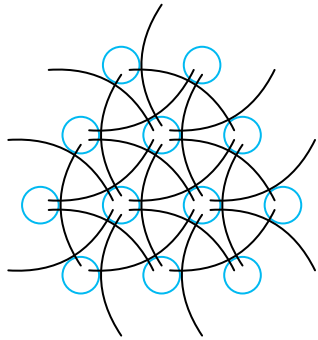
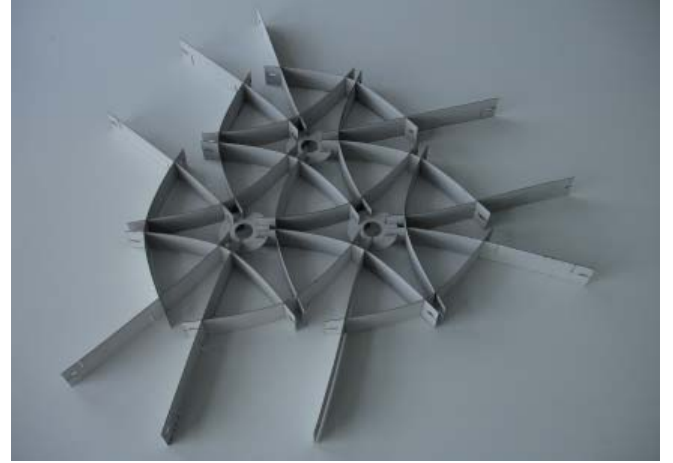
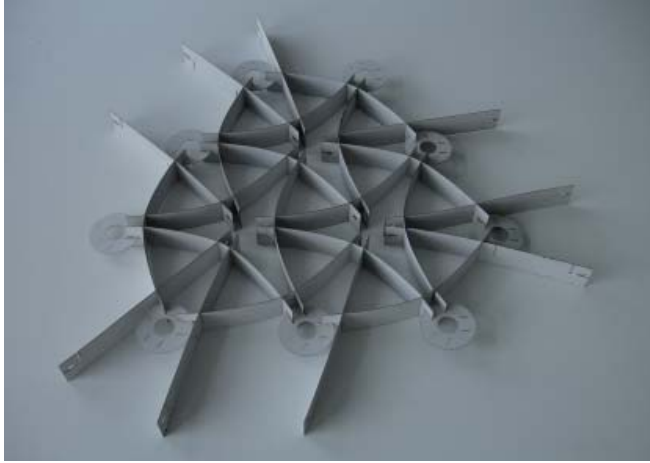
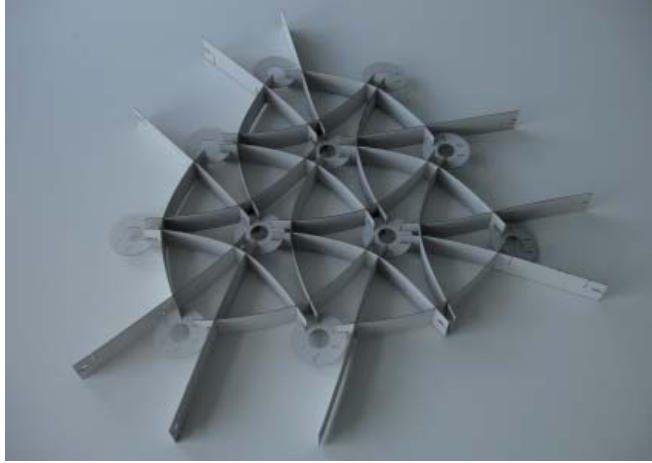

# ANALYSIS - PLAN

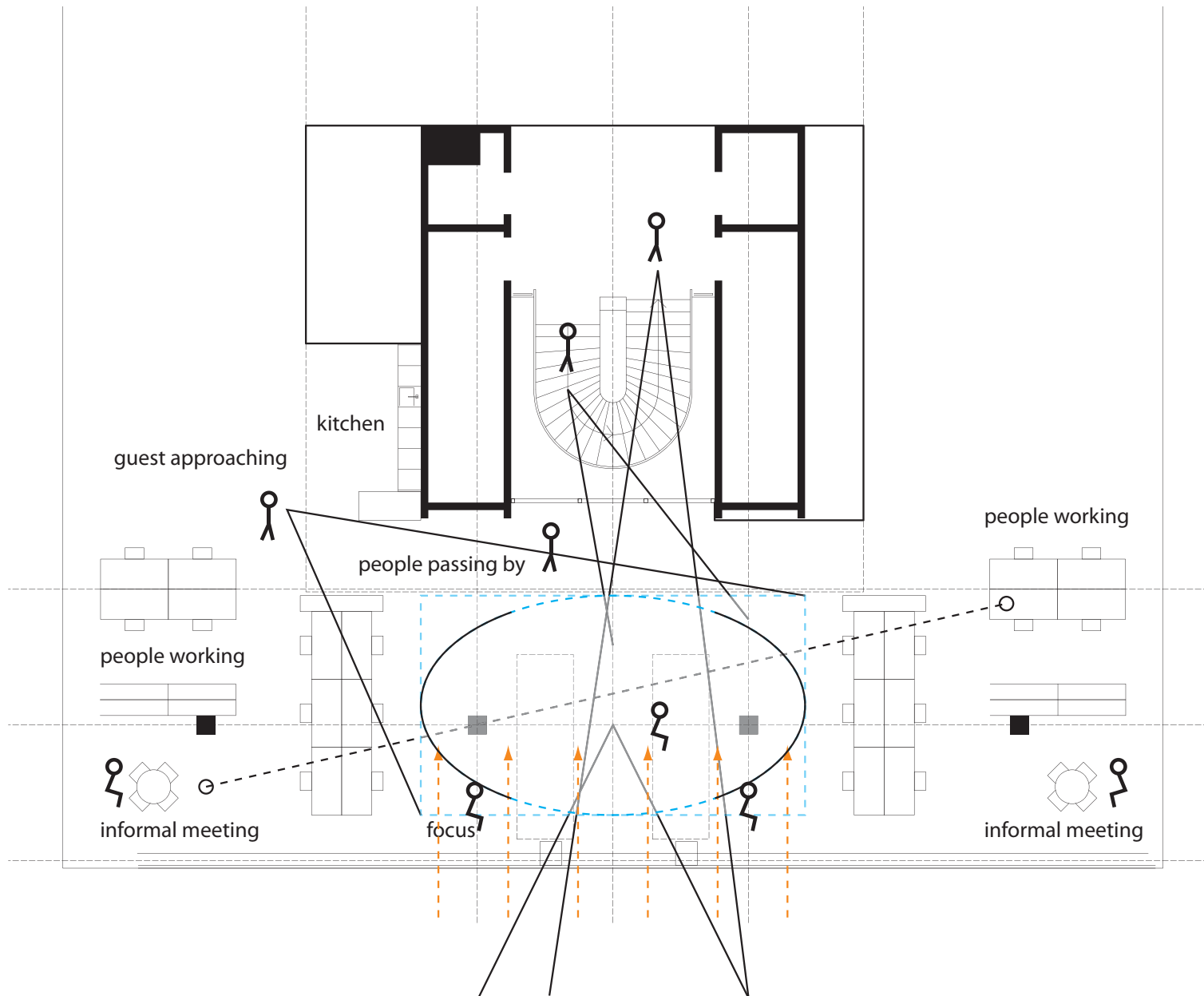

## COMPONENTS

- projector and screen
- entrance
- columns inside/outside or within structure
- shelves
- poster
- bench to allow for more guest inside
- resting area outside
- panel in ceiling for heating, ventilation and light
- relationship to facade
- fire escape along facade and core 1.2m

# ANALYSIS - SECTION

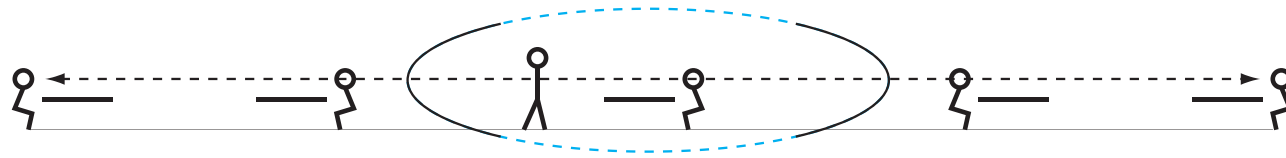

Longitudinal / SPACE

Want to create individual spaces but not separating two wings of the layout

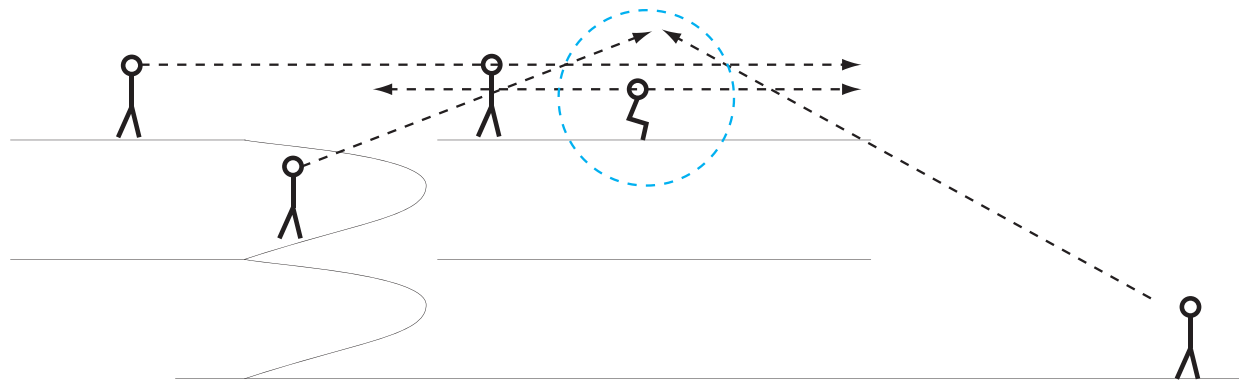

Transversal / CONNECTION

Want to create connections to the surrounding

1. people passing by inside the building
2. people approaching up the staircase should have the possibility to see if something is going on inside
3. people passing by outside should be giving a sign that this is the chair of CAAD

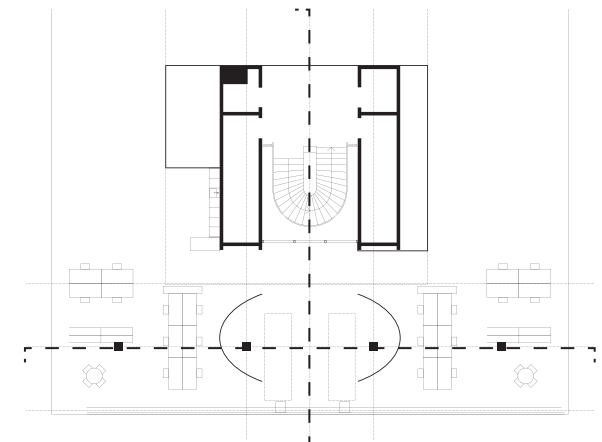

Jesper Thøger Christensen

# A TWISTED CYLINDER

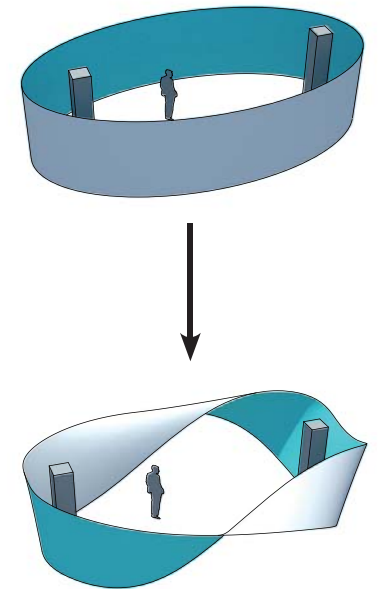
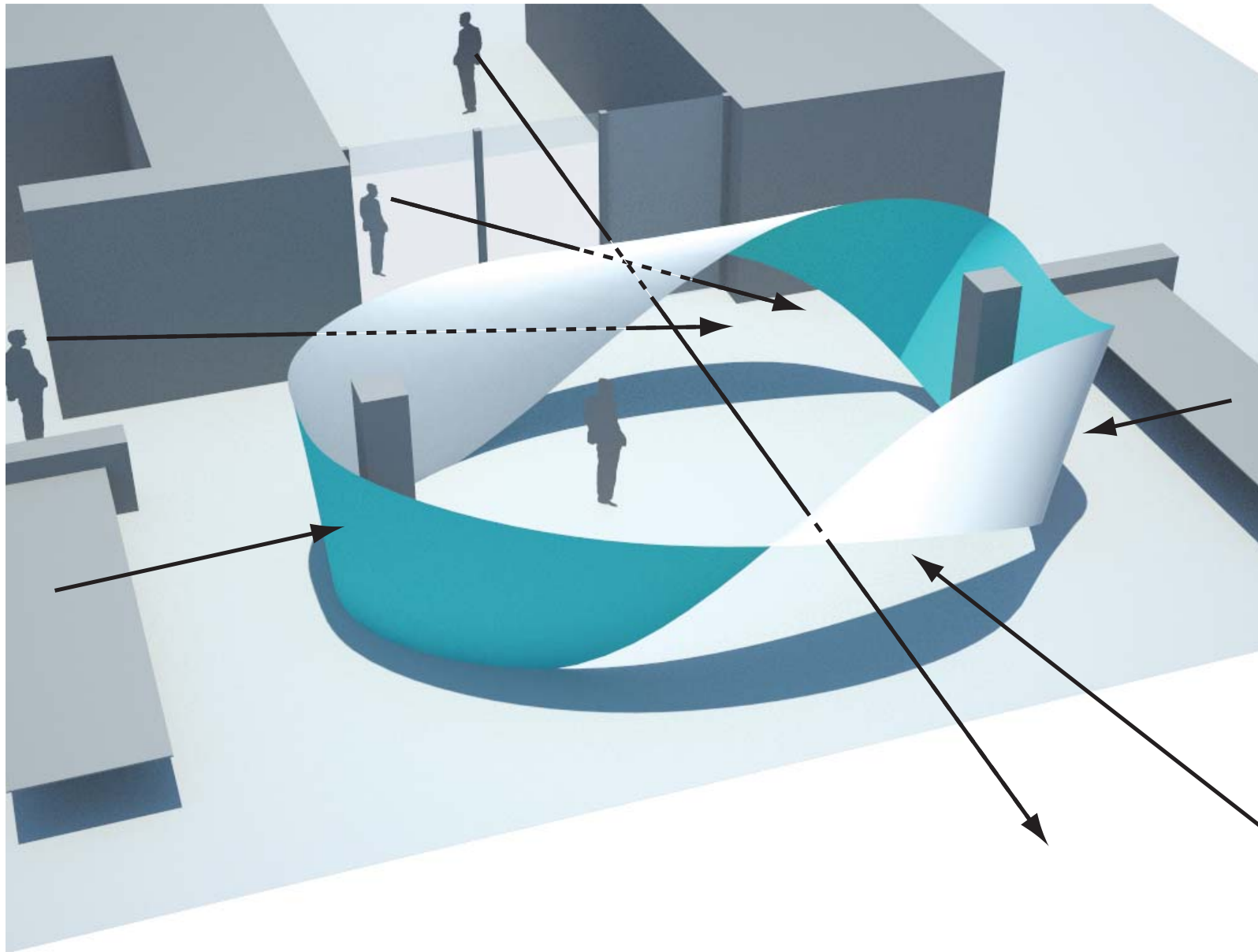

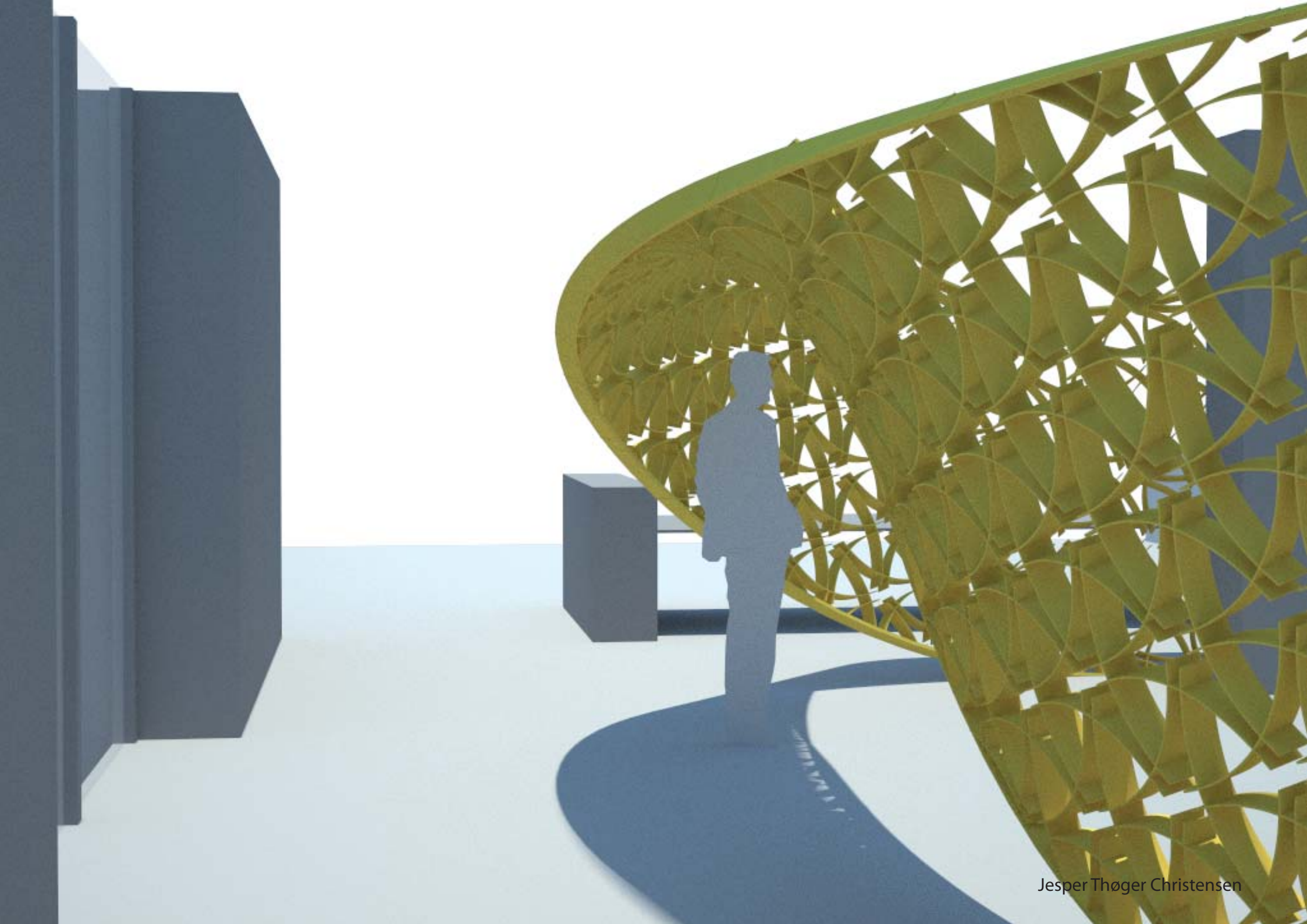



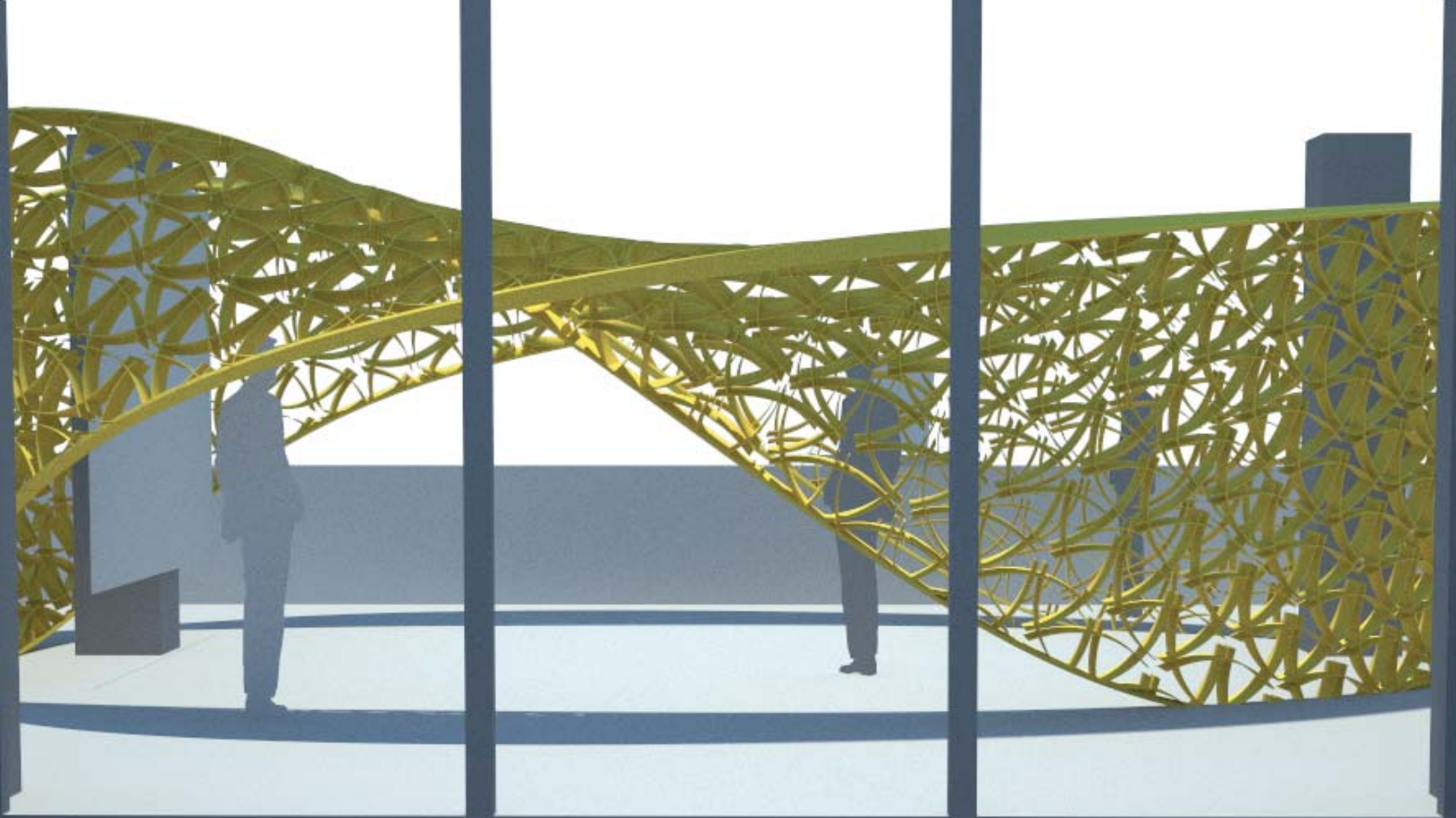

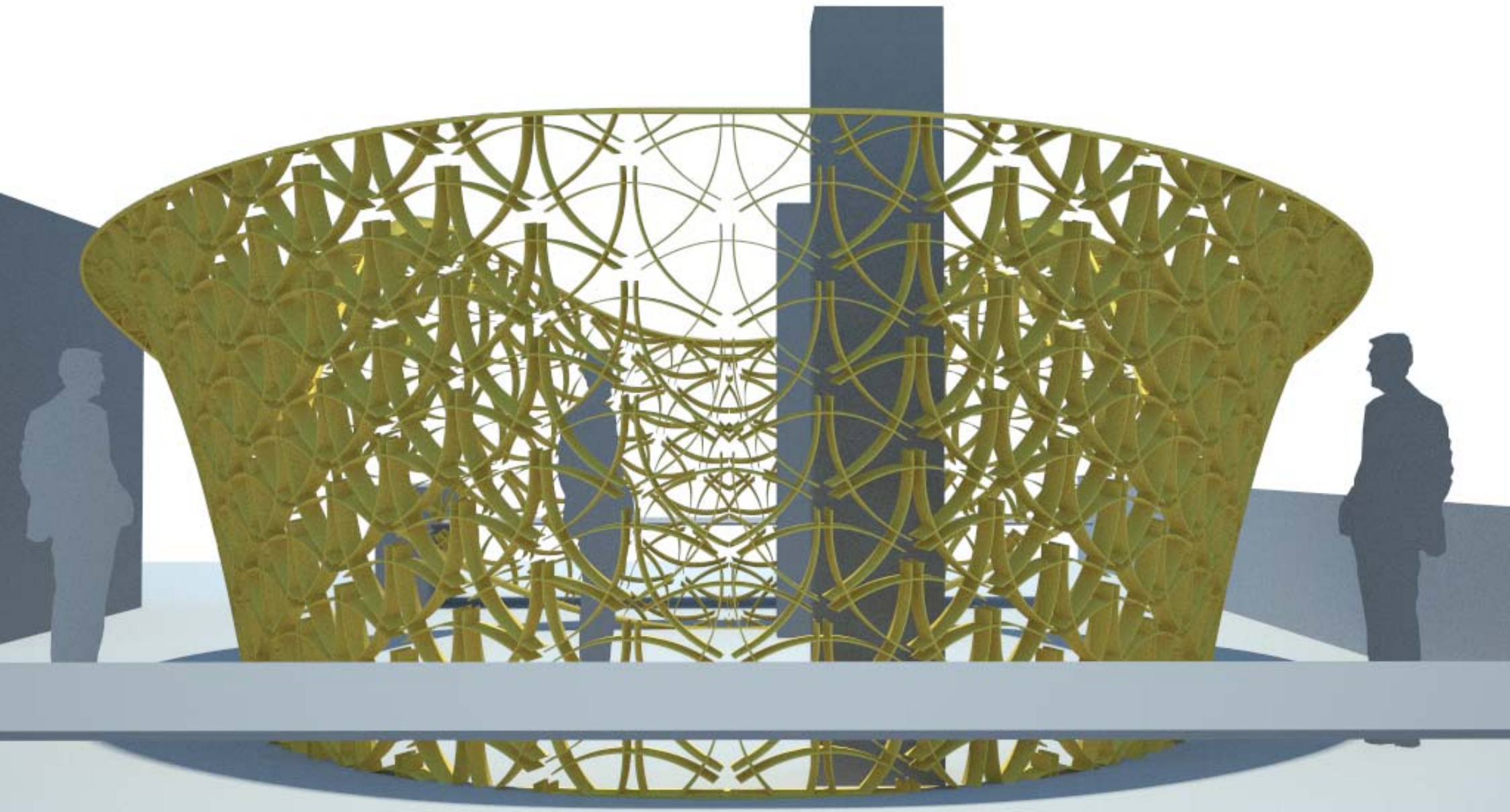

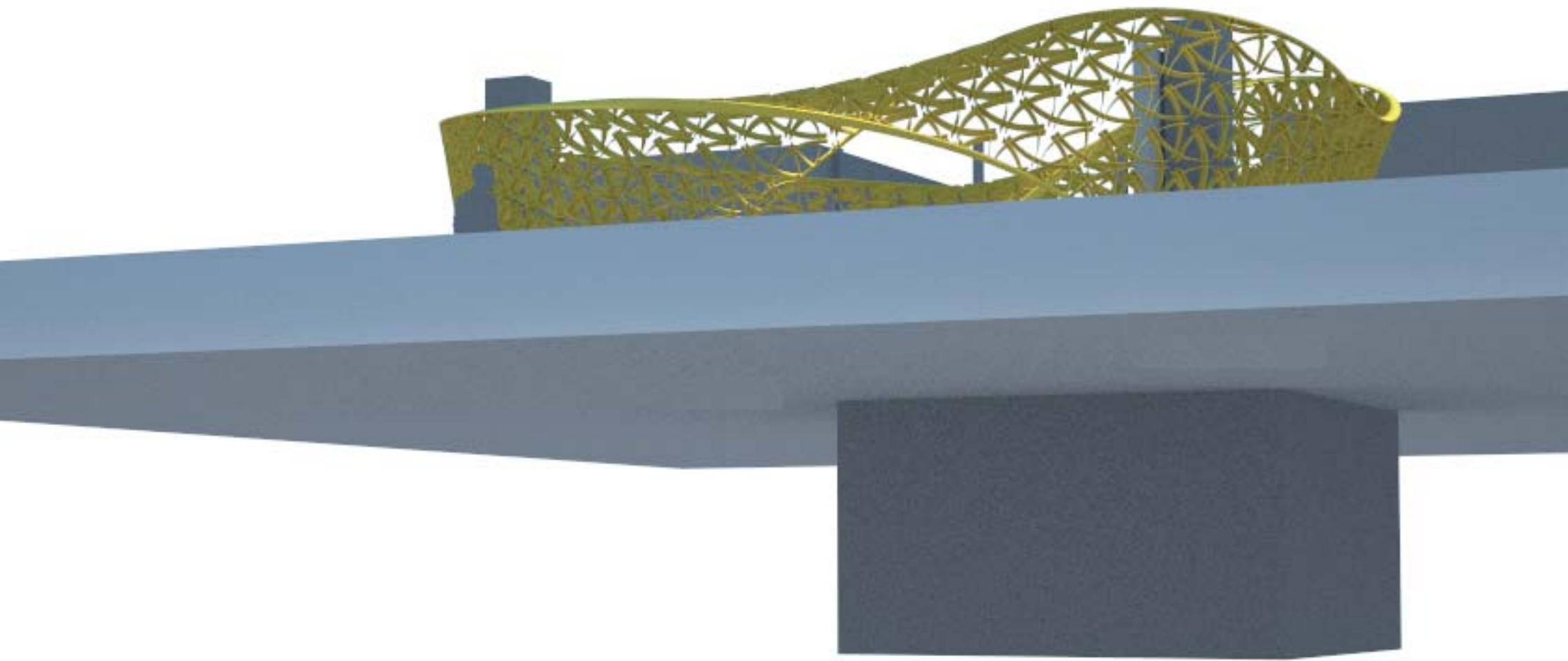

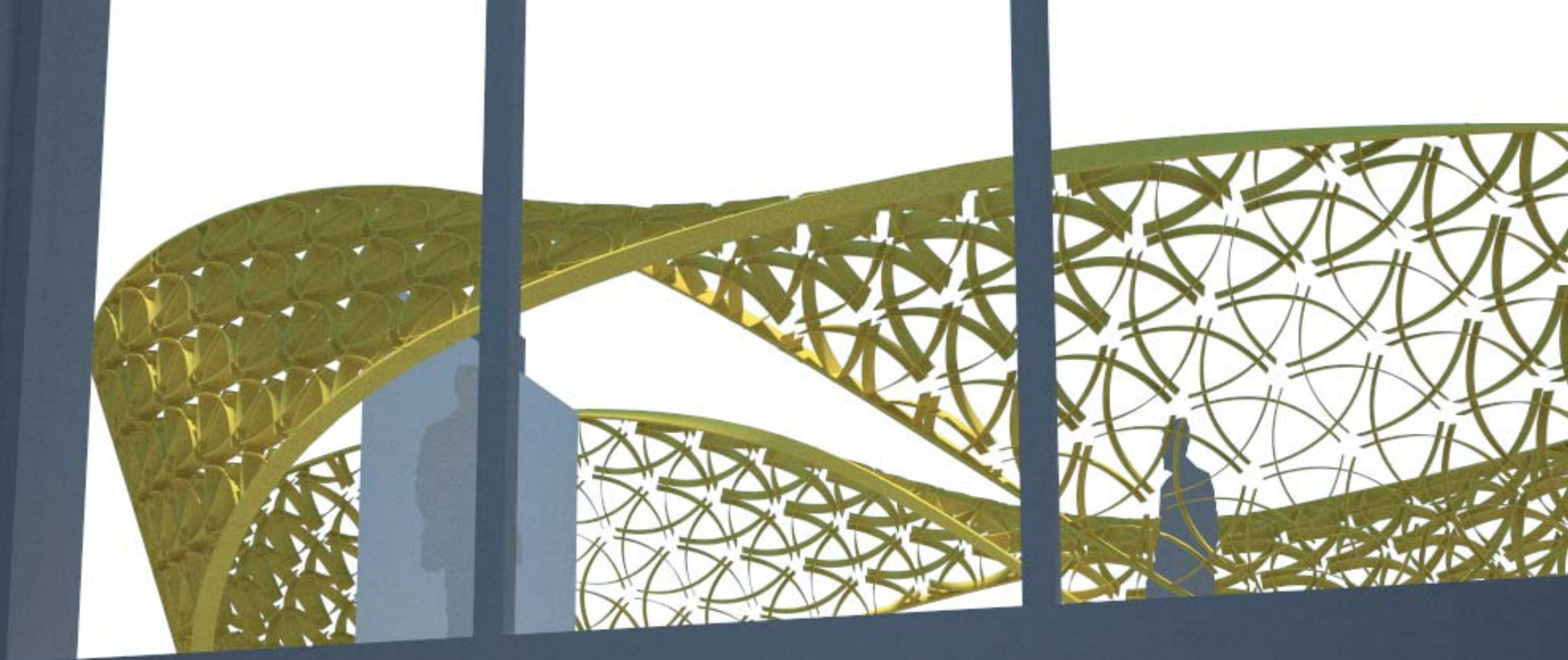

Jesper Thøger Christensen

# PAPERSTRIP MODELS

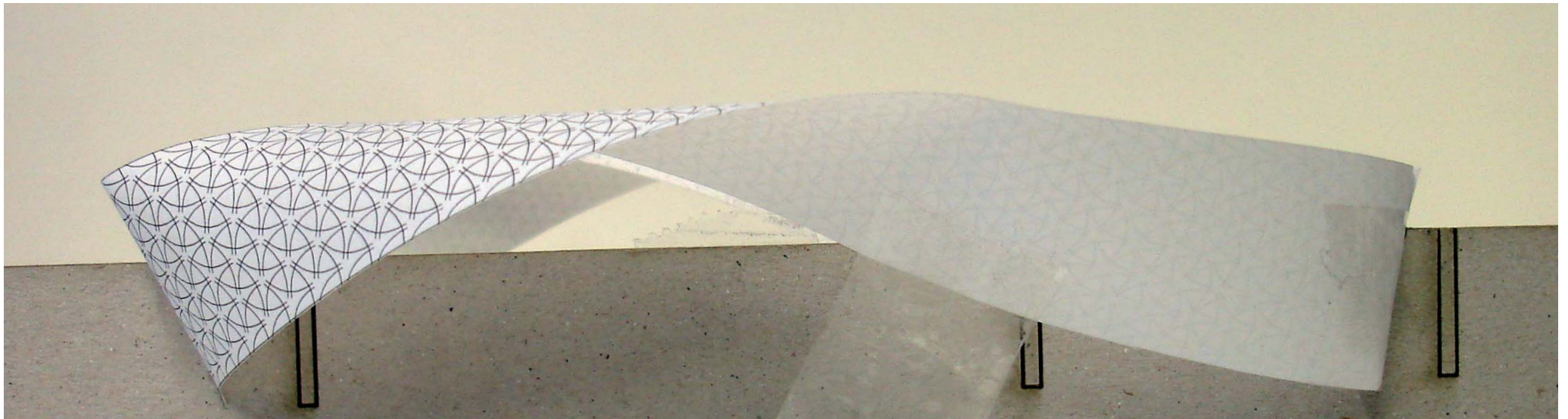
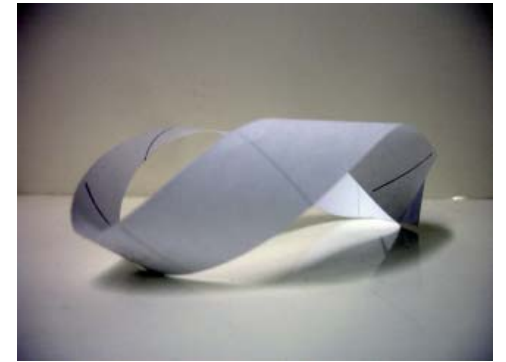
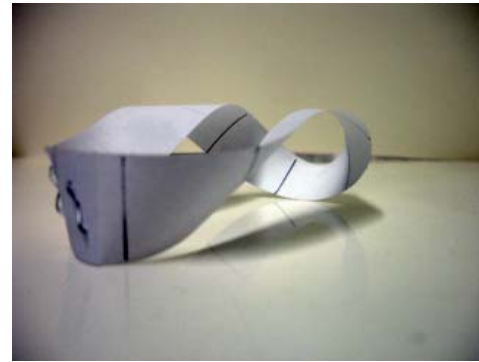
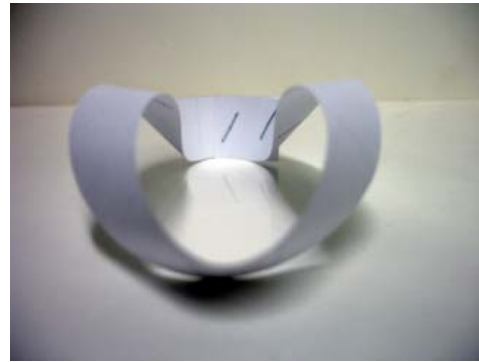
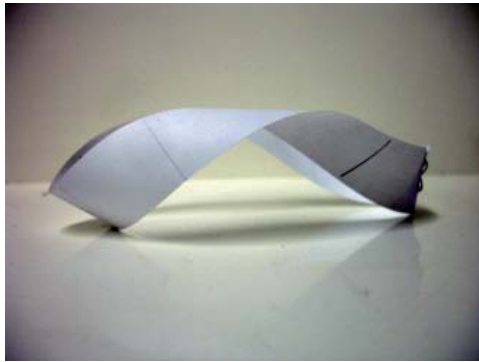

# STRUCTURAL CONSIDERATIONS

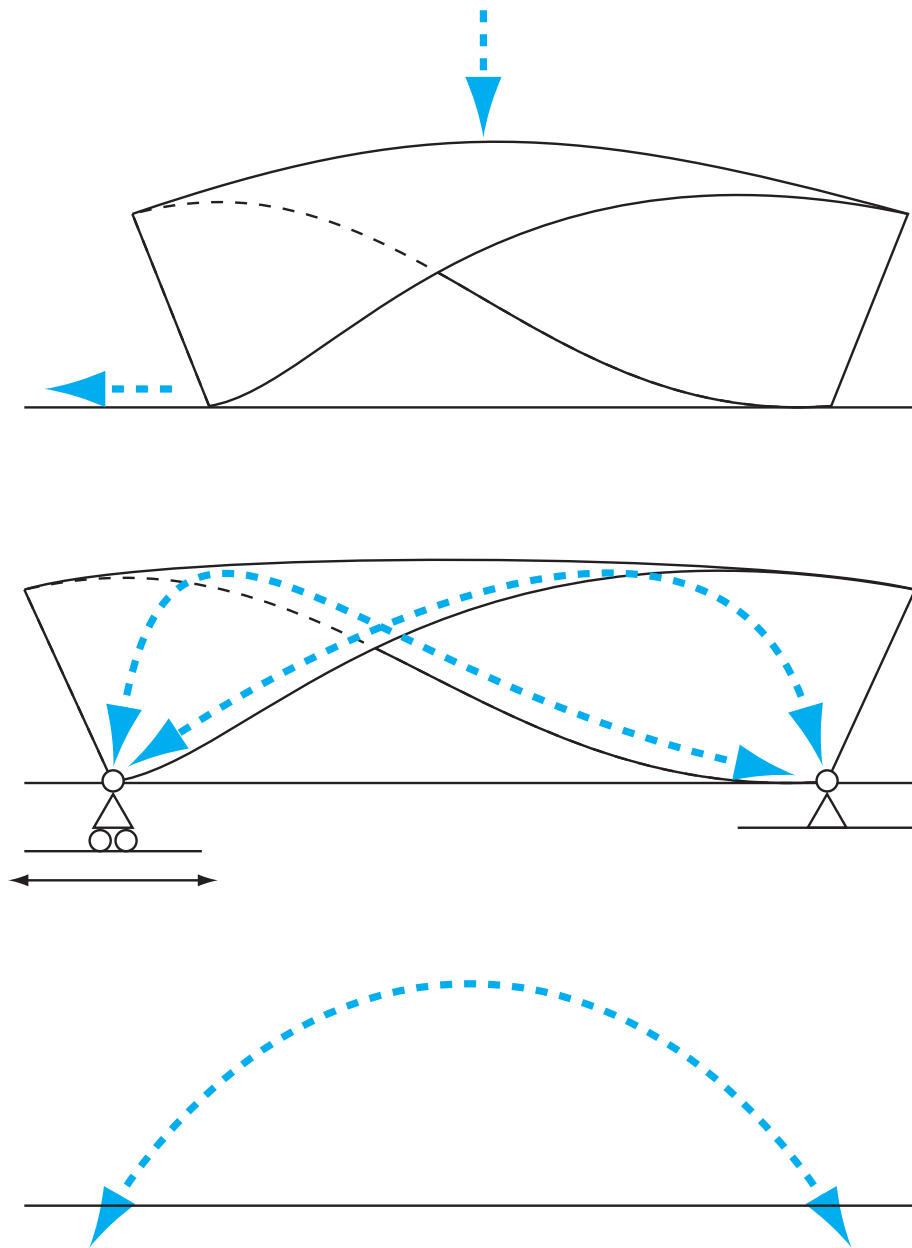

# WHAT'S NEXT



